

LAS VEGAS

ālon

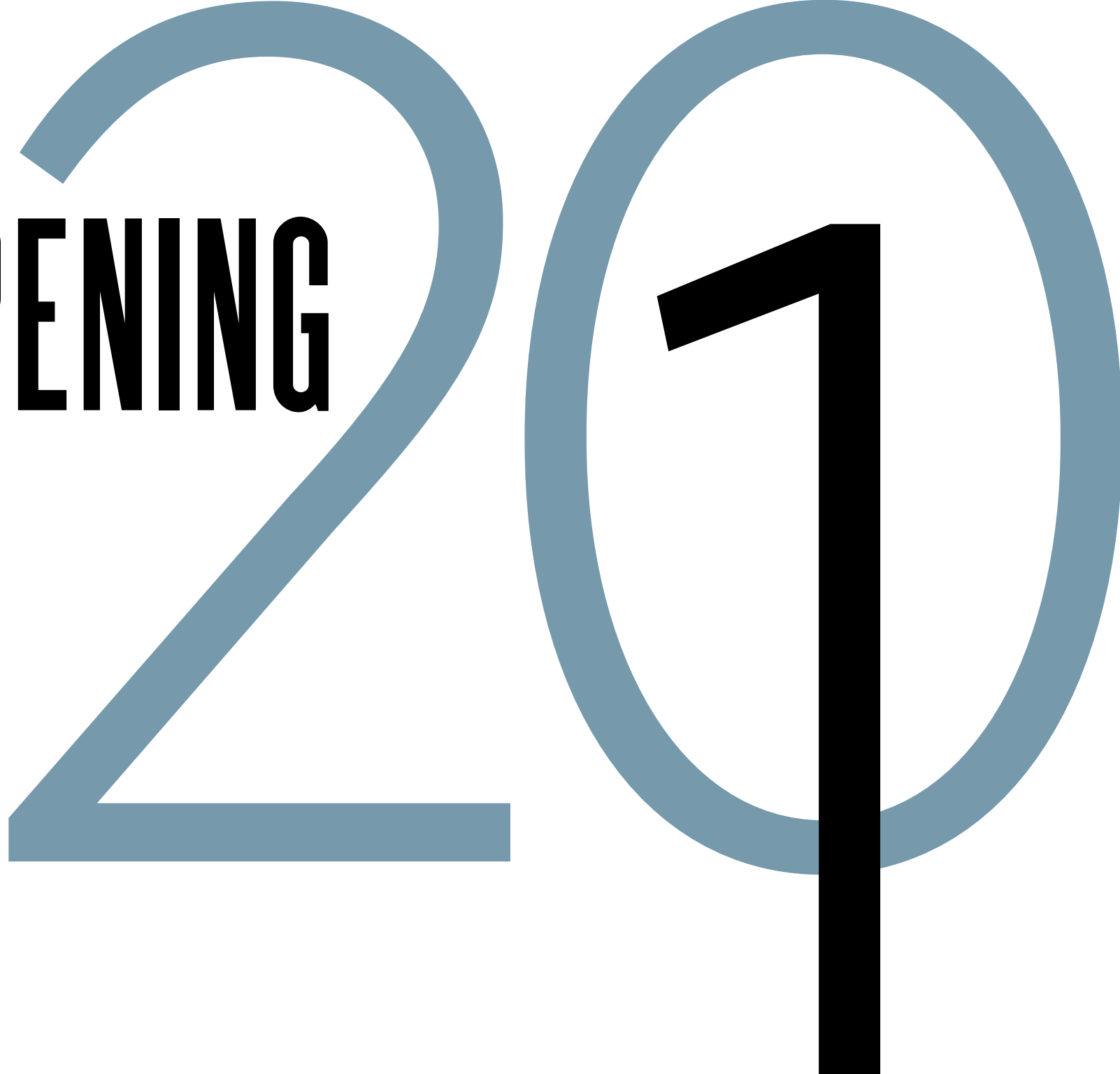

OPENING



a new name in...

LEISURE. IN ENTERTAINMENT. IN RETAIL. IN GAMING.

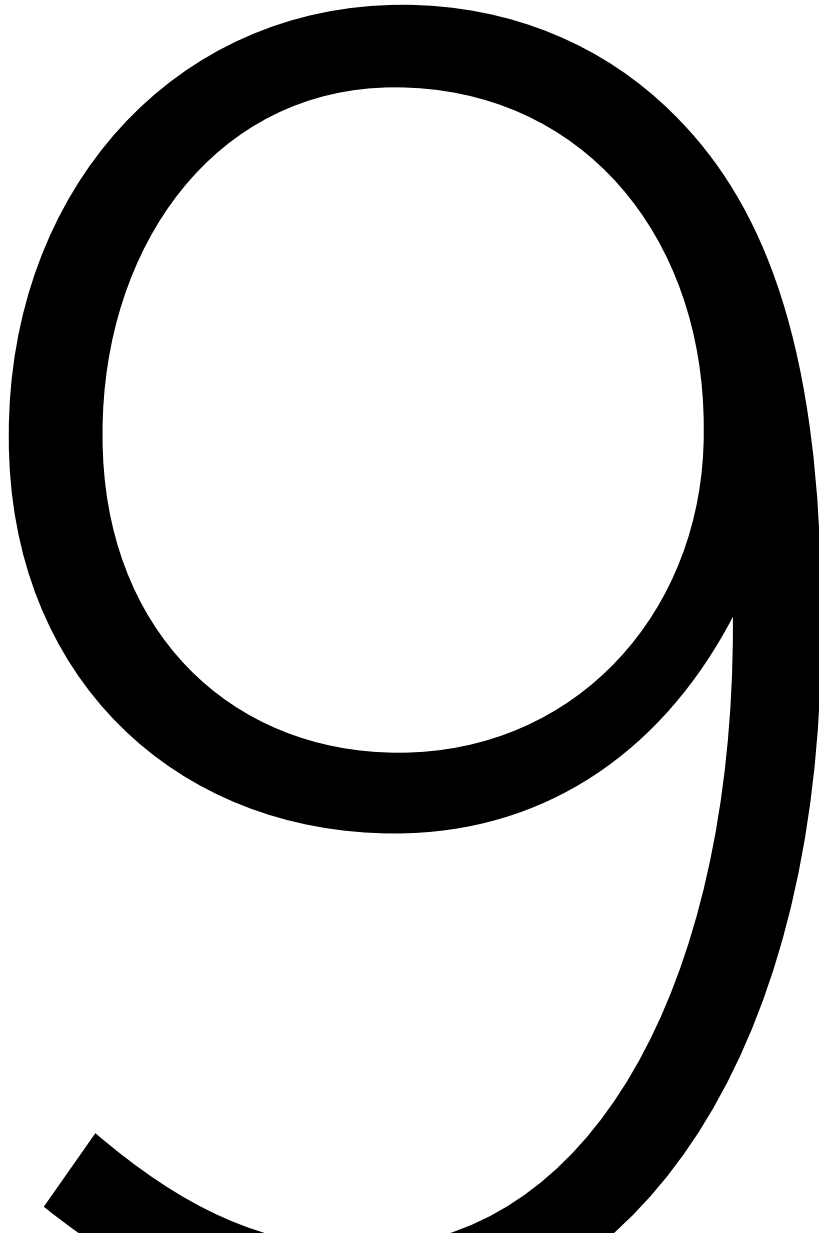

What's next for Las Vegas...when the consistent thrum of madding crowds and mega-resorts starts feeling like too much, yet not quite enough. A place for today's affluent, worldly travelers. Not all things to all people - the right things to the right people. Classic in important ways, but just fashionable enough to keep it interesting for people like us.

Alon Las Vegas.



Andrew S. Pascal

FOUNDER & CO-CHAIRMAN OF THE BOARD,
ALON LEISURE & ALON LAS VEGAS

SHARED



VISION

James D. Packer

CO-FOUNDER & CO-CHAIRMAN OF THE BOARD,
ALON LEISURE & ALON LAS VEGAS
MAJORITY SHAREHOLDER, CROWN RESORTS

A NEW SCALE AND STANDARD OF EXCELLENCE FOR LAS VEGAS IN WHICH SMALLER ISN'T LESS...

More focused. More intimate. More exclusive.
More real. More sophisticated architecture.
More international interior design.
More choices: for how to eat, and when;
for where to shop, and how; for what qualifies
as “entertainment.” A casino with more flair.
A theater with more surprises. A club with a
lot more style. And most important: more of
the right people who will shape — and have
— more of the most memorable
experiences Las Vegas has to offer.

IT'S

MORE.

What we are talking
about when
we talk about

alon

You know it when you're in it:
how it feels to be in a moment
you know you'll never forget.
How music sounds when the night sky
is star-flecked and the air is silent and still.
How a woman wears confidence
and a man wears style...not so much
aspirational...as achieved.
A place for dreamers who get things done.
And doers who can't stop dreaming.

vitality

brío





zest

flair

élan

dash

spirit



ACHIEVEMENT
-ORIENTED

HIGHLY SELF-AWARE,
yet cosmopolitan in their tastes

PASSIONATELY
DETERMINED

SELF-DIRECTED

SOCIAL
In every sense



PASSIONATELY
DETERMINED

STATUS-CONSCIOUS,
but not driven by that

TYPE a

Welcome to the Post-Demographic Age

Our guests aren't defined by age or income
as much as they are by the lives they lead.

Achievement-oriented.

Self-directed.

Passionately determined.

Highly self-aware,
yet cosmopolitan in their tastes.

Status-conscious, but not driven by that.

Social. In every sense.

TEAM

A L O N C R E A T I V E C A P I T A L I S T S



ANDREW PASCAL
Chief Executive Officer
Alon Leisure | Alon Las Vegas



ROB OSELAND
Chief Operating Officer
Alon Leisure



SCOTT PETERSON
Chief Financial Officer
Alon Las Vegas



JAMES NOEL
Executive Vice President, Development
Alon Leisure



ROSEMARY KUROPAT
Brand Strategy & Business Development
Alon Leisure



BERNARDO URQUIETA
Creative Principal
Alon Leisure

The senior management team of Alon Las Vegas has been formed a full 30+ months out from opening to ensure that the resort we develop is built around our guests and everything we plan for them. For operating efficiencies conceived for the shortest waits and the smoothest passage. Entertainment options that add to the evening rather than force choices guests don't want to make. Rooms that are as comfortable as they are uplifting, and as stylish as they are technologically advanced. A guest experience that

delivers on every promise the brand makes, every day. Under the leadership of CEO Andrew Pascal, our full-time executive Alon team blends innovative thinking with demonstrated industry knowledge and success to create value. For our guests. Our owners and partners. And for our colleagues. We think about common moments in uncommon ways. We are innovators and risk takers. We don't want only to build a great resort. **We want to build a great experience.**



DANIELLE BABILINO
Executive Vice President, Sales & Marketing
Alon Las Vegas



JENNIFER DUNNE
Vice President, Entertainment
Alon Las Vegas



MARC GUARINO
Vice President, Information Technology
Alon Las Vegas



DEBORRAH ONG
Vice President, Hotel Operations
Alon Las Vegas



CY WAITS
Co-Managing Director, Social Experience,
Alon Las Vegas



JESSE WAITS
Co-Managing Director, Social Experience,
Alon Las Vegas

LEVEL 1 ONLY. MEETING SPACES ON THE TERRACES ARE NOT SHOWN.

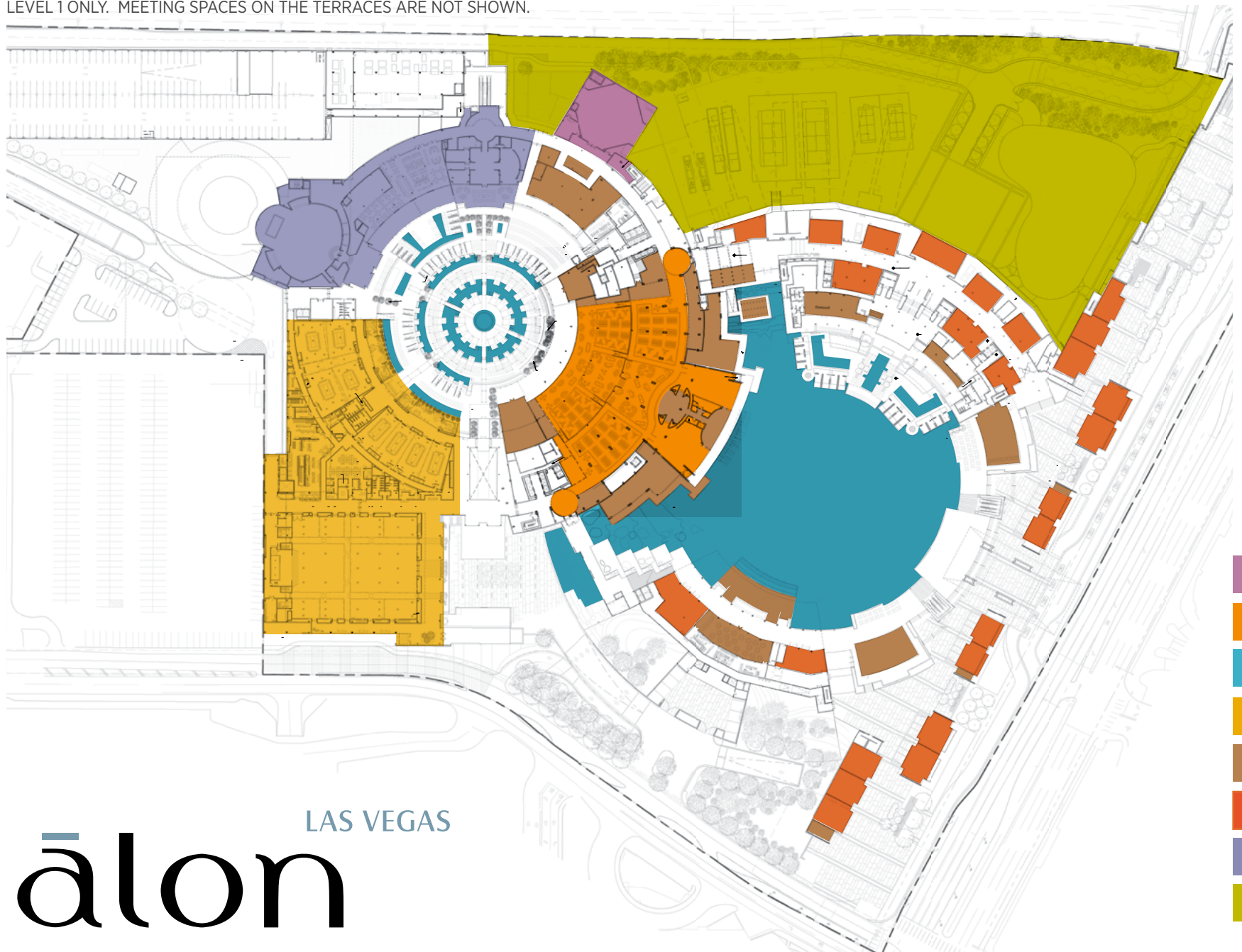

LAS VEGAS

ālon

A FULLY INTEGRATED RESORT

theater & performance space
gaming
the waters
meetings & events space
restaurants, lounges, bars
retail
the social club
the event lawn

...BALANCED BY INTIMACY

With nearly four million square feet of space under development, it's hard to call the resort small.

Yet, there is an intimacy made possible by architecture that is as sensitive as it is modern, as discrete as it is light-filled and refreshing.

Hallways that curve offer no resistance...

and yet promise surprise. Sightlines that cross open spaces offer views that beckon, and a perfect idea of what comes next. Here, shoppers will stroll.

Sunbathers will lounge. Players will roll the dice.

And glasses will rise as surely as the sun will set each night, and guests will dance the night away.

Just as we planned.

Within walking distance from Alon Las Vegas is the highest concentration of luxury shopping, restaurants and 4- and 5-star resorts on The Strip.

WHERE

LUXURY GOES...

**TO SHOP, EAT OUT, GET A MASSAGE, HAVE A FANCY COCKTAIL,
SEE A SHOW, TAKE A CHANCE, HEAR GREAT MUSIC, AND HAVE FUN!**



ā





CROWN

Alon Las Vegas is the proud partner of Crown Resorts, the pace-setting expert in hospitality and gaming in Asia and Australia. Designed for the special needs and wishes of our preferred international guests, the Crown Collection of exceptional rooms, indulgent amenities and premier services sets the pace for luxury leisure worldwide.

MEETINGS

Over 92,000 sf of highly configurable meeting space: a spectacular 24,002 sf ballroom. 14 meeting rooms, every one of them adjacent to patios for natural light, with vistas overlooking terraced gardens and pools.

Two exclusive and highly discrete private boardrooms. And a 30,000 sf events lawn that takes advantage of the region's extraordinary weather. Then when the meeting ends, an array of experiences waiting to be had just around the curve.

EVENTS

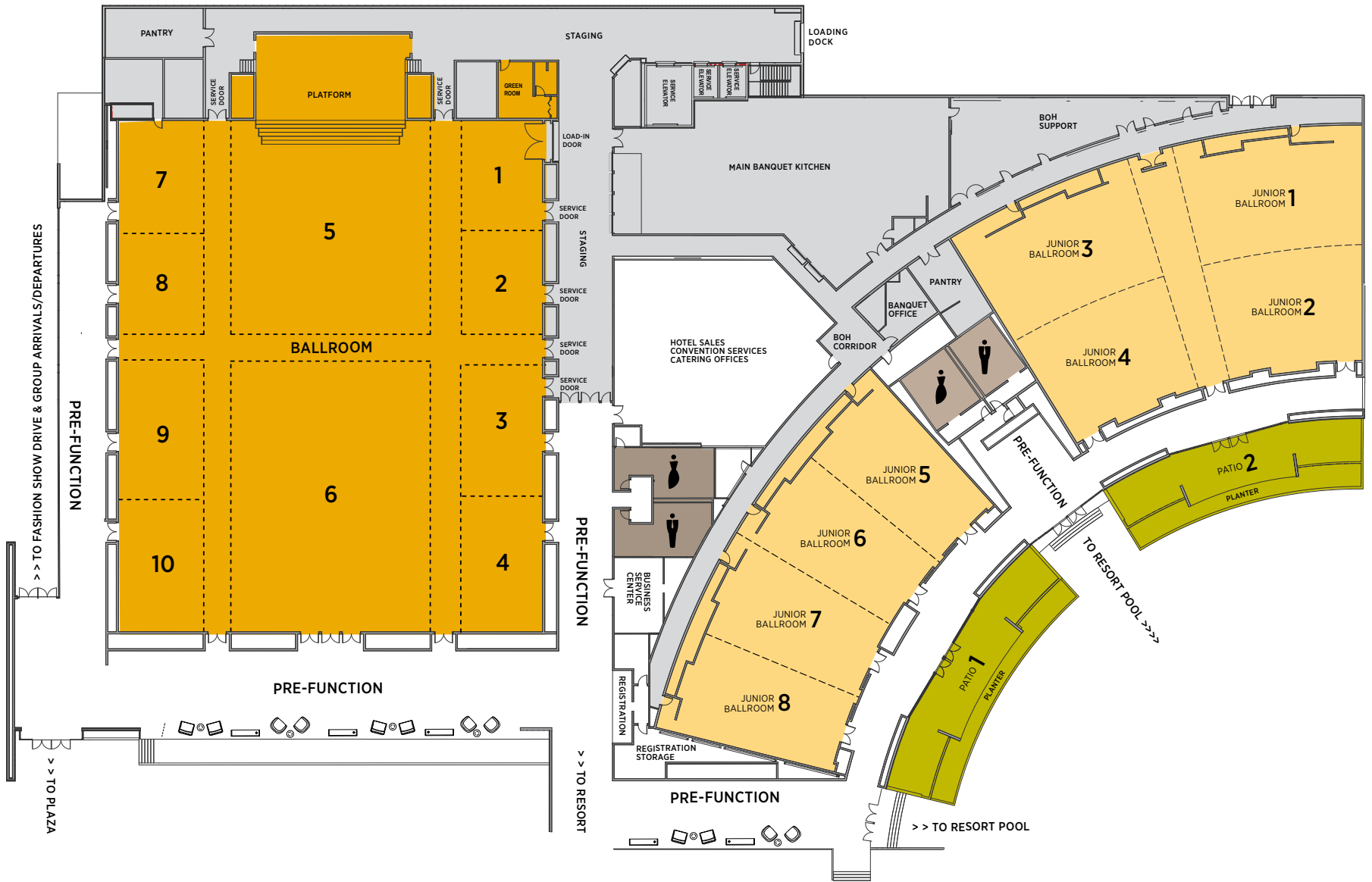

DRAWINGS ARE NOT TO SCALE. INFORMATION PRESENTED IS CORRECT AS OF MARCH 4, 2016.

CONVENING IS AN ART

Whether it is a meeting of a company's top performers and biggest thinkers...or an intimate celebration among family and friends, every event is special. And every meeting is an all-too-often rare opportunity to share thoughts and information without work's quotidian pressures ending conversations before they've really begun.

Every detail important to both planners and conferees has been considered in the design of the Conference Center...Group Arrivals and Departures is immediately adjacent to the Ballroom and a short walk from the resort's main lobby. A Banquet Kitchen is nearby, with serveries in every meeting room so food and beverage service enhances, rather than interrupts, proceedings.

The Center itself is centralized to minimize time lost to long walks from guest rooms, optimize program flow and maximize opportunities for invaluable impromptu moments amongst colleagues. Here, the conversations can begin even before the meetings commence, in intimate clusters of casual seating in our naturally lighted pre-function areas.

More than 92,000 square feet of meetings and events space, including approximately 21,000 square feet of exclusive space on the Terraces. All with quick and ready access to the SEC and LVCC. Because every meeting should be convenient, and every event, special.



CAPACITIES AND DIMENSIONS: BALLROOM

	W x L	SQ FT	CEILING HEIGHT	THEATER	CLASS ROOM	RNDS 10	RECEPTION (FLOW)	HOLLOW SQ	CONF	8' X 10' EXHIBITS	10' X 10' EXHIBITS
BALLROOM	172' x 142'	24,002	24'	1,786	1,380	1,430	1,900	n/a	n/a	146	130
1	37' x 28'	1,052	24'	84	36	40	100	36	24	4	4
2	35' x 28'	993	24'	84	36	40	100	36	22	5	5
3	45' x 28'	1,296	24'	108	54	60	130	48	46	5	5
4	46' x 28'	1,371	24'	108	54	60	140	48	50	7	7
5	72' x 67'	4,414	24'	448	216	230	400	96	n/a	21	16
6	91' x 67'	6,083	24'	616	324	330	550	120	n/a	35	28
7	38' x 29'	1,083	24'	84	36	40	100	36	24	5	5
8	34' x 29'	967	24'	84	36	40	100	36	22	5	5
9	47' x 29'	1,332	24'	108	54	60	140	48	50	6	6
10	44' x 29'	1,216	24'	102	45	60	130	48	44	7	7
1,2	72' x 28'	2,045	24'	192	90	100	180	72	44	9	9
3,4	91' x 28'	2,667	24'	252	117	140	180	90	50	13	13
5,6	172' x 67'	11,091	24'	1,204	621	630	1,300	n/a	n/a	66	54
7,8	72' x 29'	2,050	24'	192	90	100	180	72	42	10	10
9,10	91' x 29'	2,548	24'	252	117	140	200	90	50	14	14
3,4,6	91' x 104'	9,502	24'	700	540	560	650	n/a	n/a	55	49
6,9,10	91' x 105'	9,502	24'	700	540	560	650	n/a	n/a	56	49
1,2,5,7,8	81' x 142'	11,075	24'	1,330	540	640	1,300	n/a	n/a	59	53
3,4,6,9,10	91' x 142'	12,928	24'	1,340	720	760	1,500	n/a	n/a	77	69
REG DESK	12'	160	16'	n/a	n/a	n/a	n/a	n/a	n/a	n/a	n/a
GREEN ROOM	19' x 17'	278	10'	n/a	n/a	n/a	n/a	n/a	n/a	n/a	n/a

As of 3/4/16; square footage, capacities, and dimensions are based on pre-construction drawings; final figures may vary. Classroom is 3 per 6' table. All functions greater than 300 persons will be subject to Fire Marshall approval. Junior Ballroom dimensions are averages due to the shape of the rooms. Capacity figures do not account for head tables, dance floors, or audio visual requirements and final set-up number is subject to Fire Marshall approval. Ballroom stage is 50' x 16'; ceiling height of 22'. The height of the stage is 42" and is measured from the floor to top of the stage.



CAPACITIES AND DIMENSIONS: JUNIOR BALLROOMS

	W x L	SQ FT	CEILING HEIGHT	THEATER	CLASS ROOM	RNDS 10	RECEPTION (FLOW)	HOLLOW SQ	CONF	8' X 10' EXHIBITS	10' X 10' EXHIBITS
JUNIOR BALLROOM 1	140' x 61'	7,047	18'	688	306	370	600	n/a	n/a	n/a	n/a
5	30' x 61'	1,768	18'	151	66	80	150	54	56	n/a	n/a
6	30' x 61'	1,754	18'	157	63	80	150	54	56	n/a	n/a
7	30' x 61'	1,756	18'	157	63	80	150	54	56	n/a	n/a
8	30' x 61'	1,769	18'	151	66	80	150	54	56	n/a	n/a
5, 6	60' x 61'	3,522	18'	336	144	170	350	75	64	n/a	n/a
6, 7	60' x 61'	3,510	18'	336	144	170	350	75	64	n/a	n/a
7, 8	60' x 61'	3,525	18'	336	144	170	350	75	64	n/a	n/a
5, 6, 7	90' x 61'	5,278	18'	450	234	270	500	105	n/a	n/a	n/a
6, 7, 8	90' x 61'	5,279	18'	450	234	280	500	105	n/a	n/a	n/a
JUNIOR BALLROOM 2	125' x 80'	9,491	18'	720	438	540	1,400	n/a	n/a	n/a	
1	52' x 41'	2,236	18'	157	87	90	200	66	50	n/a	n/a
2	52' x 39'	1,951	18'	140	72	80	160	54	42	n/a	n/a
3	54' x 41'	2,318	18'	164	90	110	200	66	50	n/a	n/a
4	54' x 39'	1,973	18'	140	72	80	160	54	42	n/a	n/a
1, 2	52' x 80'	4,187	18'	398	177	200	360	93	92	n/a	n/a
3, 4	54' x 80'	4,291	18'	413	180	210	360	93	92	n/a	n/a
PATIO 1	89' x 16'	1,464	n/a	n/a	n/a	100	150	n/a	n/a	n/a	n/a
PATIO 2	89' x 16'	1,370	n/a	n/a	n/a	100	130	n/a	n/a	n/a	n/a

As of 3/4/16; square footage, capacities, and dimensions are based on pre-construction drawings; final figures may vary. Classroom is 3 per 6' table. All functions greater than 300 persons will be subject to Fire Marshall approval. Junior Ballroom dimensions are averages due to the shape of the rooms. Capacity figures do not account for head tables, dance floors, or audio visual requirements and final set-up number is subject to Fire Marshall approval. Ballroom stage is 50' x 16'; ceiling height of 22'. The height of the stage is 42" and is measured from the floor to top of the stage.

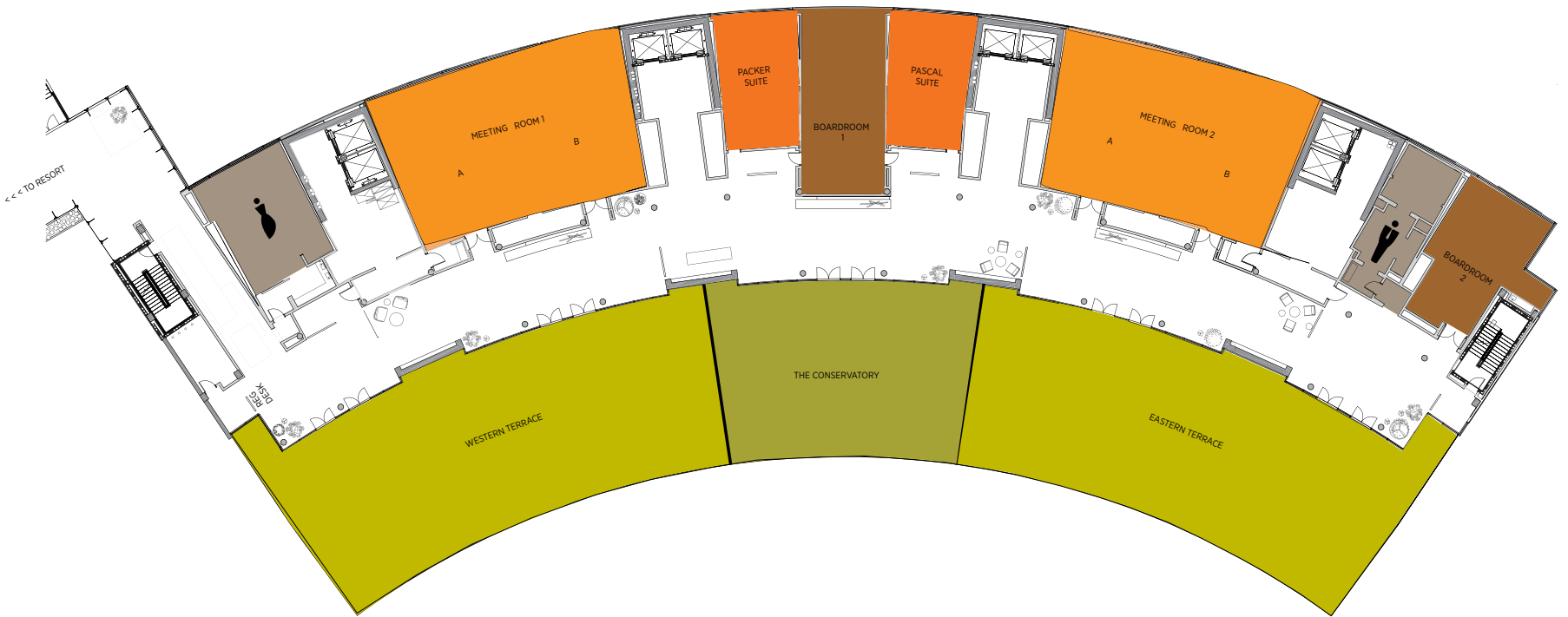

DRAWINGS ARE NOT TO SCALE.
INFORMATION PRESENTED IS CORRECT AS OF MARCH 4, 2016.

CAPACITIES AND DIMENSIONS: THE TERRACES

	W x L	SQ FT	CEILING HEIGHT	THEATER	CLASS ROOM	RNDS 10	RECEPTION (FLOW)	HOLLOW SQ	CONF	8' X 10' EXHIBITS	10' X 10' EXHIBITS
Meeting 1	62' x 41'	2,814	13'	200	150	150	250	90	80	n/a	n/a
A	31' x 41'	1,407	13'	100	75	75	125	45	40	n/a	n/a
B	31' x 41'	1,407	13'	100	75	75	125	45	40	n/a	n/a
Meeting 2	62' x 41'	2,814	13'	200	150	150	250	90	80	n/a	n/a
A	31' x 41'	1,407	13'	100	75	75	125	45	40	n/a	n/a
B	31' x 41'	1,407	13'	100	75	75	125	45	40	n/a	n/a
Boardroom 1 (Existing Table)	47' x 21'	1,016	13'	n/a	n/a	n/a	n/a	n/a	20	n/a	n/a
Boardroom 2 (Existing Table)	38' x 34'	905	13'	n/a	n/a	n/a	n/a	n/a	10	n/a	n/a
The Packer Suite	21' x 20'	670	13'	n/a	n/a	n/a	n/a	n/a	n/a	n/a	n/a
The Pascal Suite	21' x 20'	668	13'	n/a	n/a	n/a	n/a	n/a	n/a	n/a	n/a
The Conservatory	66' x 45'	2,875	n/a	350	n/a	n/a	225	n/a	n/a	n/a	n/a
Western Terrace	115' x 45'	4,698	n/a	n/a	n/a	270	450	n/a	n/a	n/a	n/a
Eastern Terrace	117' x 45'	4,771	n/a	n/a	n/a	280	475	n/a	n/a	n/a	n/a

As of 3/4/16; square footage, capacities, and dimensions are based on pre-construction drawings; final figures may vary. Classroom is 3 per 6' table. All functions greater than 300 persons will be subject to Fire Marshall approval. Junior Ballroom dimensions are averages due to the shape of the rooms. Capacity figures do not account for head tables, dance floors, or audio visual requirements and final set-up number is subject to Fire Marshall approval. Ballroom stage is 50' x 16'; ceiling height of 22'. The height of the stage is 42" and is measured from the floor to top of the stage. *Executive Meeting Suites have permanent seating for 5 people.

By 1829, Mexican merchants regularly traveled the Old Spanish Trail to Los Angeles. So concerned were these intrepid businessmen for their safe passage through the arid southwest that they employed scouts to find the hospitality that Nature offered along the Trail: water and an angle of shade. Perhaps the coolness of green, water-fed growth to refresh them. Raphael Rivera was just the sort of scout who recognized the signs of water: the dry earth would give way to the lush green growth that gave Las Vegas its name... for in his native tongue, Rivera dubbed this place...

THE MEADOWS

Today, we celebrate the rich, natural heritage of Las Vegas with more than 30,000 square feet of green space in our own front yard. A great lawn, surrounded by a leisurely walking path, and outfitted to host grand outdoor celebrations or smaller ones concurrently. An herb and vegetable garden will meet the needs of our chefs for ultimately fresh flavors. The Meadows will offer our guests a most modern version of what those long ago travelers once sought: an oasis.



EVENT LAWN



O P E N I N G



20
19

ALON LAS VEGAS DEVELOPMENT CENTER

3128 South Las Vegas Boulevard
Las Vegas, NV 89109

T 725.877.7000 **F** 725.877.7432 **E** sales@alonly.com **URL** alonly.com

MAILING ADDRESS:

10150 Covington Cross Drive
Las Vegas, NV 89144

DANIELLE BABILINO

Executive Vice President, Hotel Sales & Marketing

JOHN ROMFO

Executive Director, Leisure Sales & Hotel Marketing

JARED MINTZ

Director, Convention Sales

The information contained herein is correct as of March 4, 2016.

To download the latest version of this brochure, please visit alonly.com or **CLICK HERE.**



FOR MORE INFORMATION:

ALON LAS VEGAS 10150 Covington Cross Drive Las Vegas, NV 89144 **T** 725.877.7000 **F** 725.877.7432 **E** sales@alonly.com **alonly.com**

